

ᏰᏍᏍᏁ ᏌᏍᏍᏁ
**THINK
CHEROKEE**



LABOR DAY - MEMORIAL DAY

9 AM - 5 PM

Closed on Sundays and Mondays

MEMORIAL DAY - LABOR DAY

9 AM - 5 PM

Closed on Sundays

Closed January 1-14, Thanksgiving Day,
Christmas Eve and Christmas Day

CHEROKEE SATURDAYS

First Saturday of each month, federally recognized Cherokee citizens and a guest receive free admission. Does not apply to special events.

ADULTS \$8.50

CHILDREN K-12 \$5.00

STUDENTS WITH ID \$7.50

SENIORS (55 AND OLDER) \$7.50

Admission price includes all attractions.
Prices are subject to change.

Group tours are available.

To make arrangements, email chc@cherokee.org

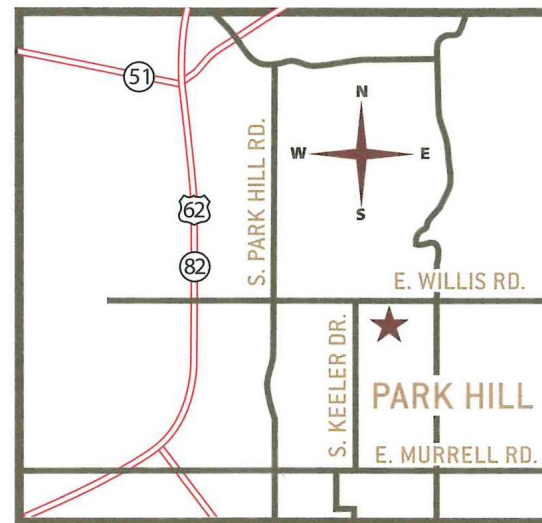

DIRECTIONS Located six miles south of downtown Tahlequah, Oklahoma. Take HWY 62 (Cherokee Hills Scenic Byway), to historic Park Hill, turn east on Willis Road. Follow Willis Road to South Keeler Drive.



21192 S. KEELER DR., PARK HILL, OK 74451
(918) 456-6007 • (888) 999-6007 • FAX (918) 456-6165
CHEROKEEHERITAGE.ORG • LIKE US ON FACEBOOK
MAILING ADDRESS: PO BOX 515, TAHLEQUAH, OK 74465

For a complete list of events and activities, visit CHEROKEEHERITAGE.ORG.

LOCATED ON THE GROUNDS OF THE FIRST CHEROKEE NATIONAL FEMALE SEMINARY,

THE CHEROKEE HERITAGE CENTER WAS ESTABLISHED IN 1963 TO PRESERVE, PROMOTE AND TEACH CHEROKEE HISTORY AND CULTURE.

Today, the Cherokee Heritage Center is the heart of tribal history and culture. The museum and grounds encompass centuries of Cherokee culture that fascinate visitors with interactive exhibits, living history, cultural activities, art shows and much more.

Visit the Cherokee Heritage Center and discover the legacy that defined a nation.

Original Cherokee Female Seminary columns from 1851.



ATTRACTIONS

DILIGWA

Time travel to Diligwa – a 1710 outdoor Cherokee living village – located on the grounds of the Cherokee Heritage Center. Here, observe Cherokee life during the early eighteenth century. Villagers demonstrate traditional Cherokee crafts while explaining history and culture.

SPECIAL EXHIBIT GALLERY

This gallery houses a variety of Cherokee-themed exhibits throughout the year and features two nationally recognized Native American art shows.

CHEROKEE FAMILY RESEARCH CENTER

The Cherokee Family Research Center exists to help people research their Cherokee ancestry. Its documents, from the Trail of Tears to the Dawes enrollment, are easily accessible and Cherokee-specific. Personal exploration of one's family is encouraged and included with CHC admission.

ADAMS CORNER RURAL VILLAGE

Explore the great change in Cherokee society in the days before Oklahoma statehood. At your own pace, tour a general store, three different types of housing, a school and a church in this 1890s setting.

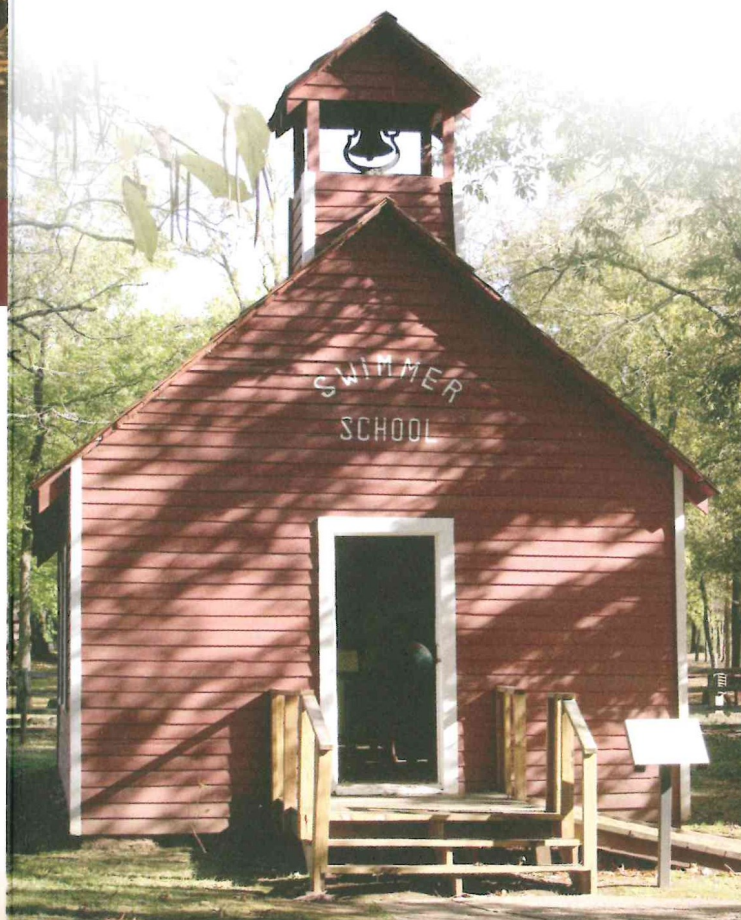

TRAIL OF TEARS EXHIBIT

The Trail of Tears exhibit chronicles the forced removal of Cherokee ancestors from their indigenous homeland to Indian Territory, present-day Oklahoma. The exhibit is staged in six galleries and includes documentation and artifacts.

MUSEUM STORE

Indulge your taste for distinctive Cherokee artwork and gifts. Choose from an extensive collection of original paintings, sculptures, Cherokee apparel, books, authentic souvenirs and more.

MEMBERSHIPS

Cherokee National Historical Society is a 501(c)(3) organization and depends on its members' and donors' support to continue presenting Cherokee history as it truly was, and Cherokee culture as it truly is. Please help the Cherokee National Historical Society continue this important mission. Become a member or donor today.